

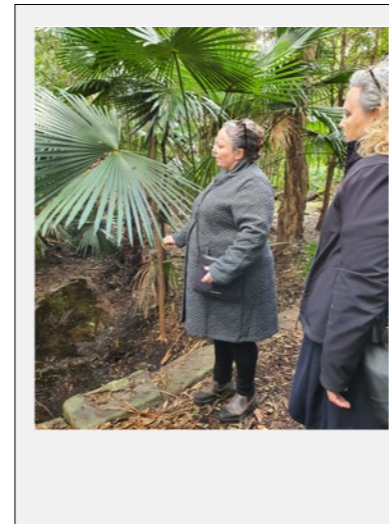

Design Process and Engagement

Knowledge Sharing - Bangawarra and Crone



20.07.08 | cloudy
The natural guttering system of the cabbage tree palm fronds.

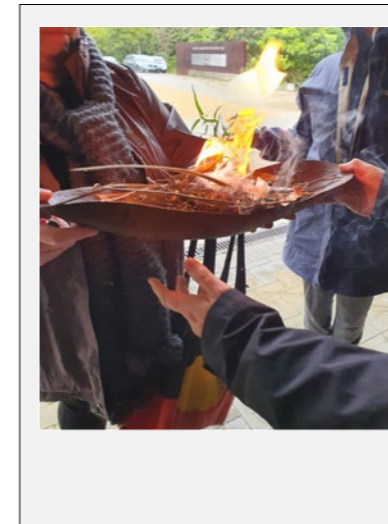

20.08.07 | raining
Welcome to Country to start the Stage 2 project.

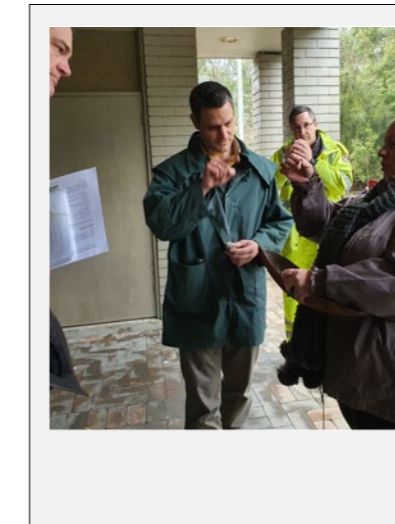

20.08.07 | raining
Sharing Knowledge with NPWS team.

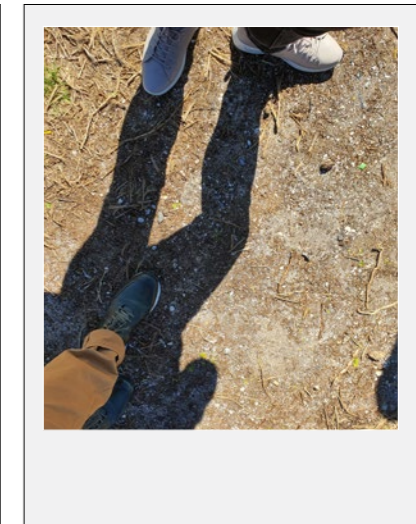

20.08.28 | sunny
Walking on Country, as we review our design proposal.

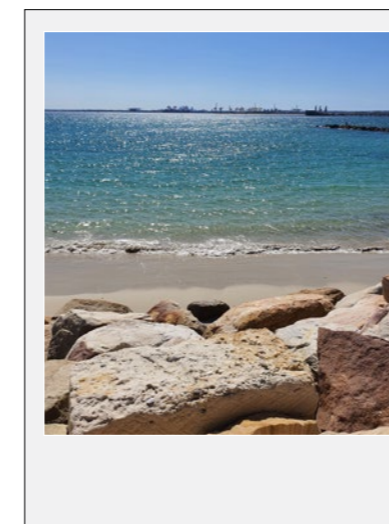

20.09.07 | sunny
Garigalo is Saltwater Country.

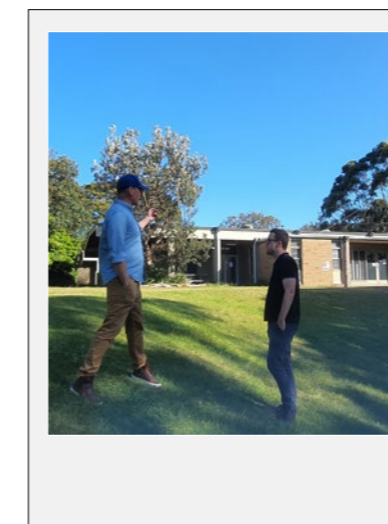

20.09.07 | sunny
Stepping out the building design on the nominated site location within the national park.

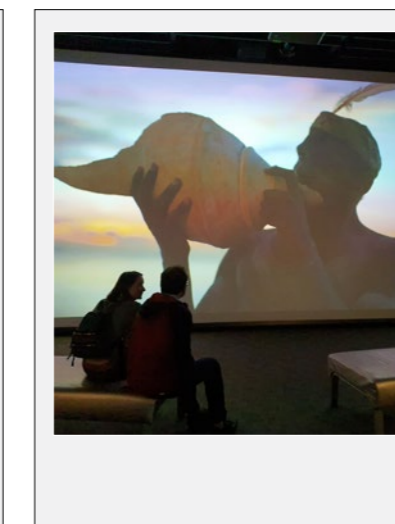

20.09.27 | cloudy and cold
A quick weekend visit to Canberra. Endeavour Voyage Exhibition Museum of Australia, Canberra.



20.10.02 | sunny
Last visit prior to project submission.

Knowledge Sharing

Moments of knowledge sharing and stories of this place: Bangawarra and Crone team site visit.

Master Plan Experiences

Loop Path/Circulation

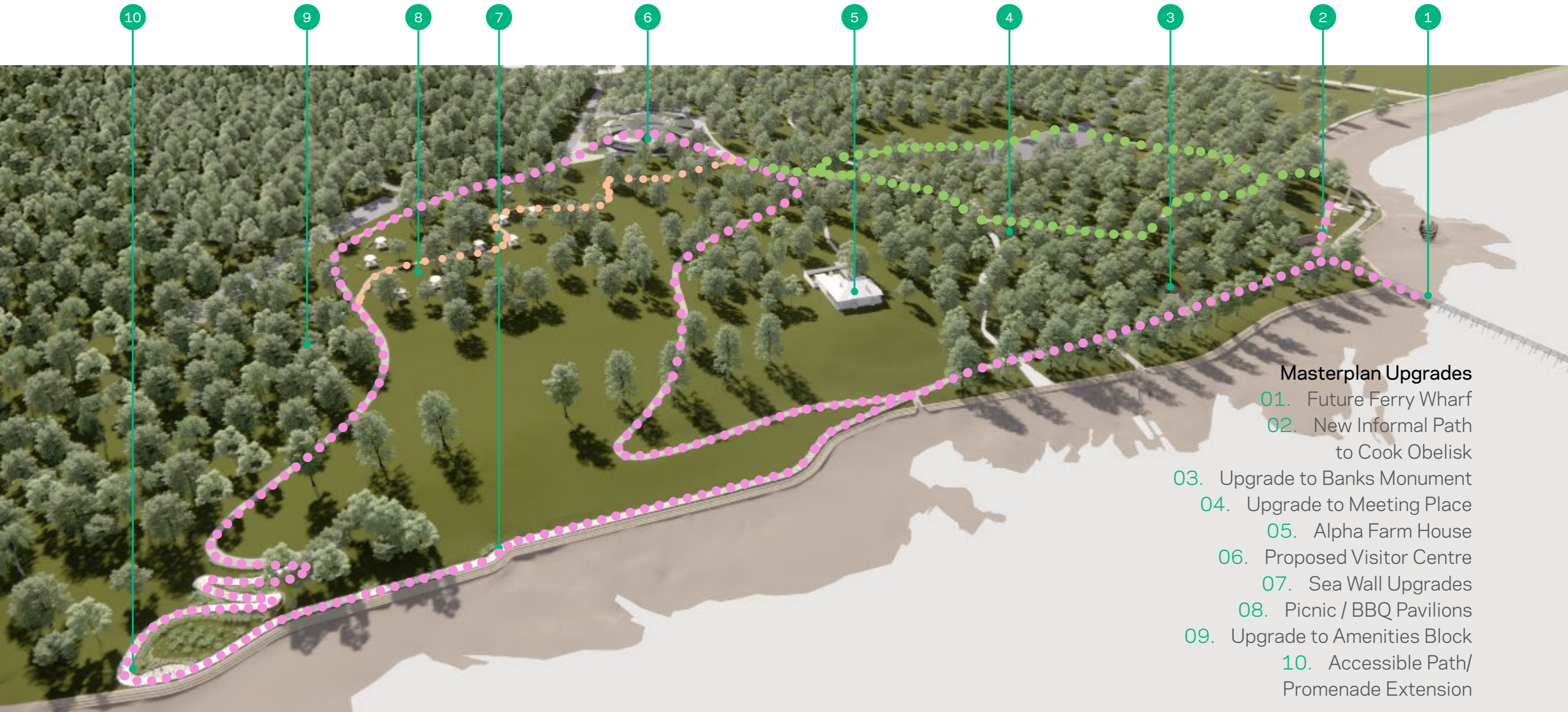

- Masterplan Upgrades**
- 01. Future Ferry Wharf
 - 02. New Informal Path to Cook Obelisk
 - 03. Upgrade to Banks Monument
 - 04. Upgrade to Meeting Place
 - 05. Alpha Farm House
 - 06. Proposed Visitor Centre
 - 07. Sea Wall Upgrades
 - 08. Picnic / BBQ Pavilions
 - 09. Upgrade to Amenities Block
 - 10. Accessible Path/ Promenade Extension

- CIRCULATION KEY**
- PRIMARY SITE LOOP / CONNECTION ●
 - ADDITIONAL LOOP TRACKS ●
 - INFORMAL PICNIC AREA THOROUGHFARE ●

Dhai'mun (Damun, Tamnun) Visitor Centre

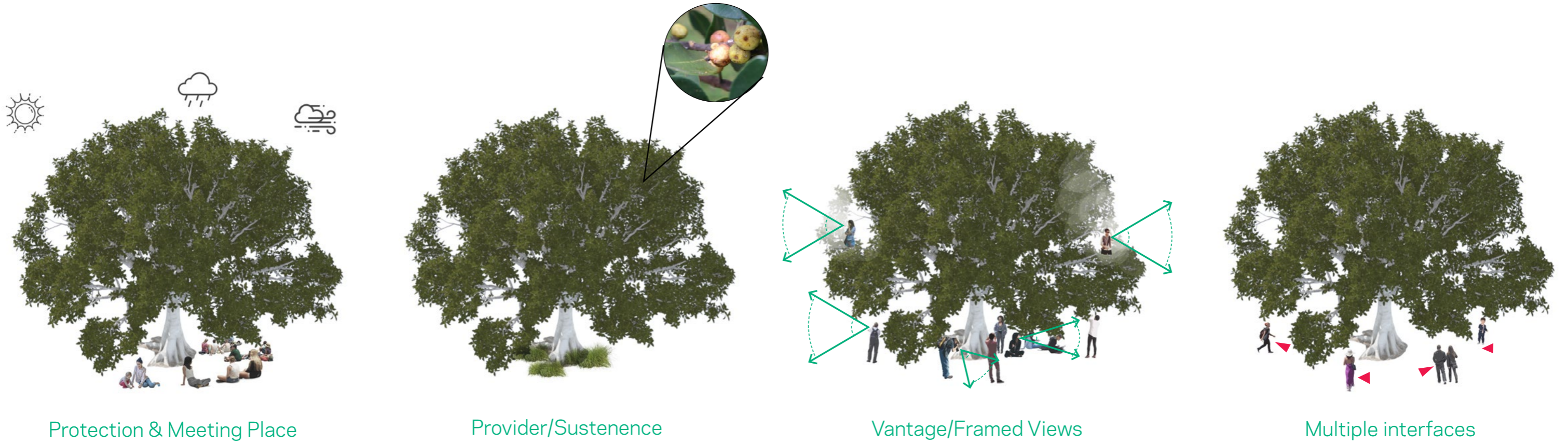

Visitor's Centre - Site Location
Aerial Perspective

Dhai'mun (Damun, Tamnun) Visitor Centre Design Principles

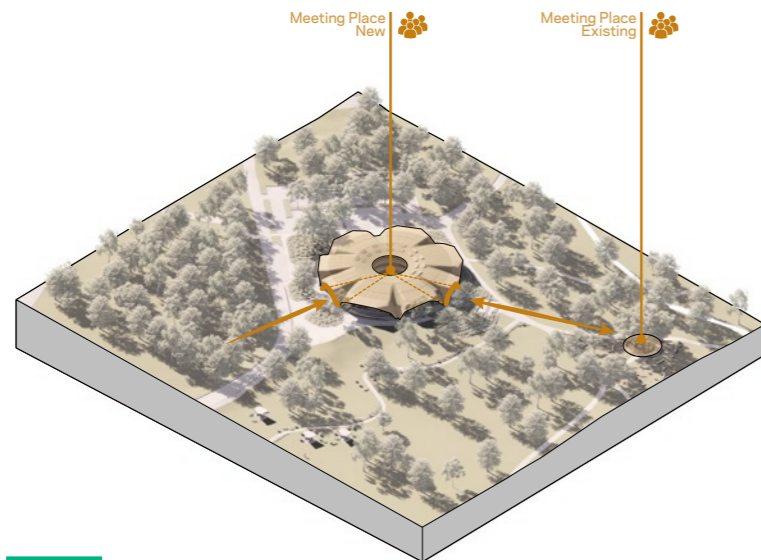

Meeting Place and Visitor Centre relationship

The project site is retained for its location with the Meeting Place, as well as minimising further archaeological disturbance on site. This allows for the Meeting Place be more integrated with the Visitor Centre through clear vistas and architectural language integration, also further amplified and enliven with an overlay of the collected stories.

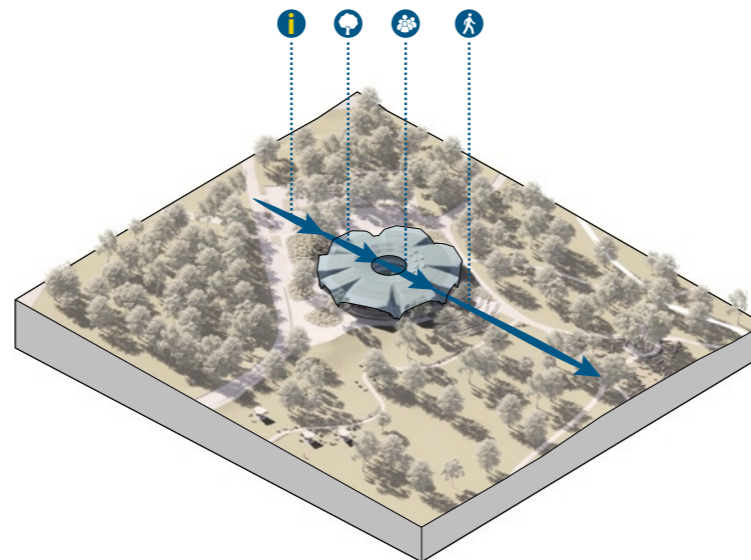

Layered Porosity

The building layout allows for programs to be layered and permeable in the arrangement. This design strategy allows for flexibility and multiple experiences, as well as enable the building to avoid a single front door, instead welcome all guests and visitors from all parts of the national park.

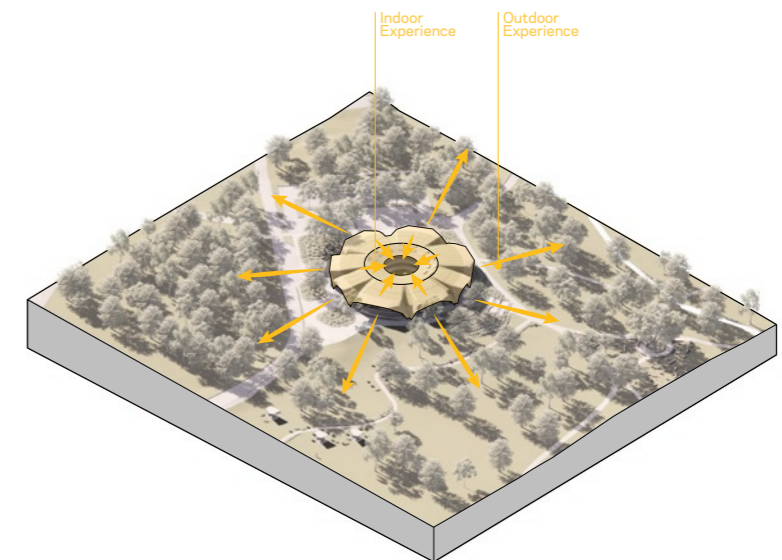

Indoor and Outdoor Experience

The wrapped nature and modular arrangement of the program provides opportunities for building users in different spaces can have a visual relationship back to other uses. Similar to the Master Plan experiences can provide both public/civic and secluded/intimate experiences, the building draws inspiration from this condition.

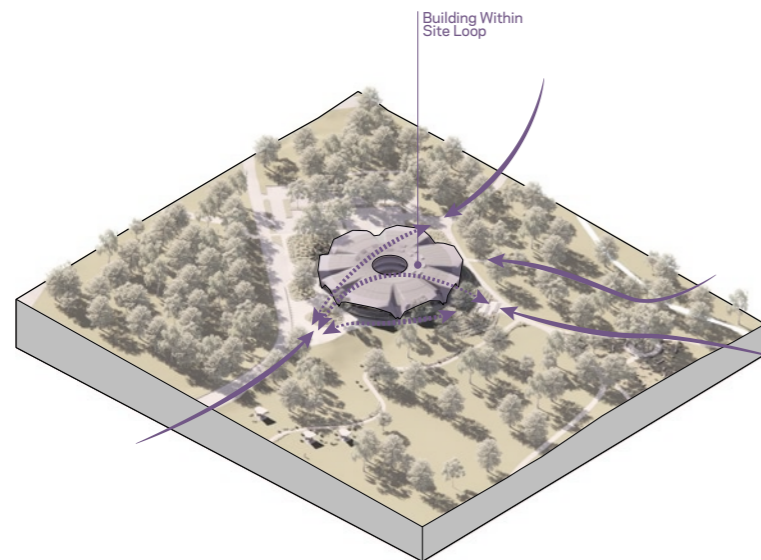

Site Loop through building

A continuous, active perimeter loop around the building and central loop allows visual prominence and interfaces with various site axis/experiences whilst an internal landscape allows a more reflective/tranquil interface. With each public program in the building having access to this dual active/meditative frontages

© 2020 Crone & Bangawarra

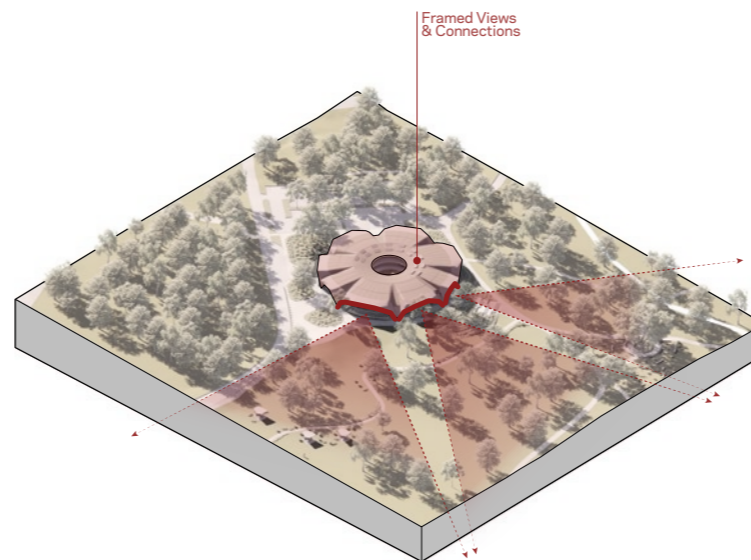

Framed Views and Connection to Country

The building organisational strategy marries the interior use/program with corresponding site vista's. These views are optimised from the more public building uses (cafe, multipurpose, education). Concrete facade 'portals' branch out to provide outlooks over Commemoration flat, Botany Bay, the Meeting Place and natural surrounds.

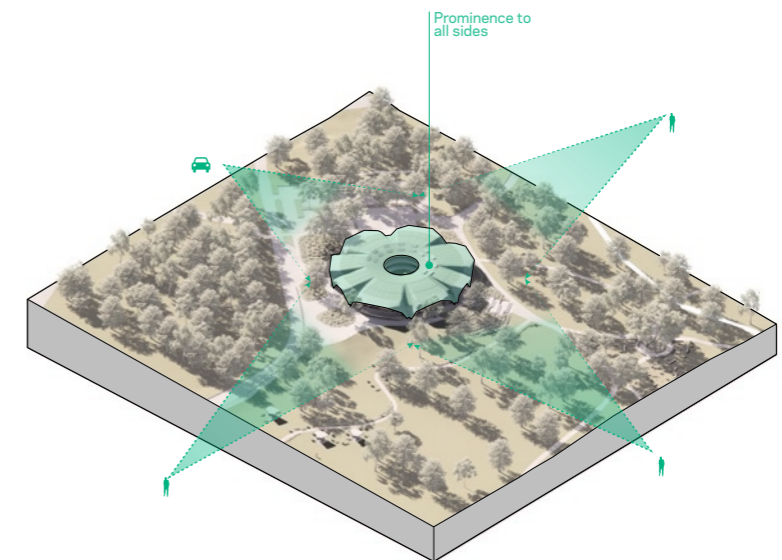

Visual Prominence

The proposed building location and form gives the Visitors Centre a strong yet sympathetic visual presence within the precinct. The minor additional building height as well as rationalisation of current visual obstructions (i.e. removal of the more invasive understorey planting surrounding the existing building) help to define the building as a clear destination point/precinct arrival by car or foot.

Dhai'mun (Damun, Tamnun) Visitor Centre Ground Floor Plan

Programs & Function

- 01. Reception and visitor information
- 02. Retail
- 03. Exhibition / Multipurpose
- 04. Cafe
- 05. The Collection Garden -
- 06. Welcome Wall Entrance
- 07. Meeting Place Arrival Hall
- 08. Amenities
- 09. Back of House and Loading
- 10. Staff Amenities
- 11. Store
- 12. Lift Access
- 13. Outdoor Terrace

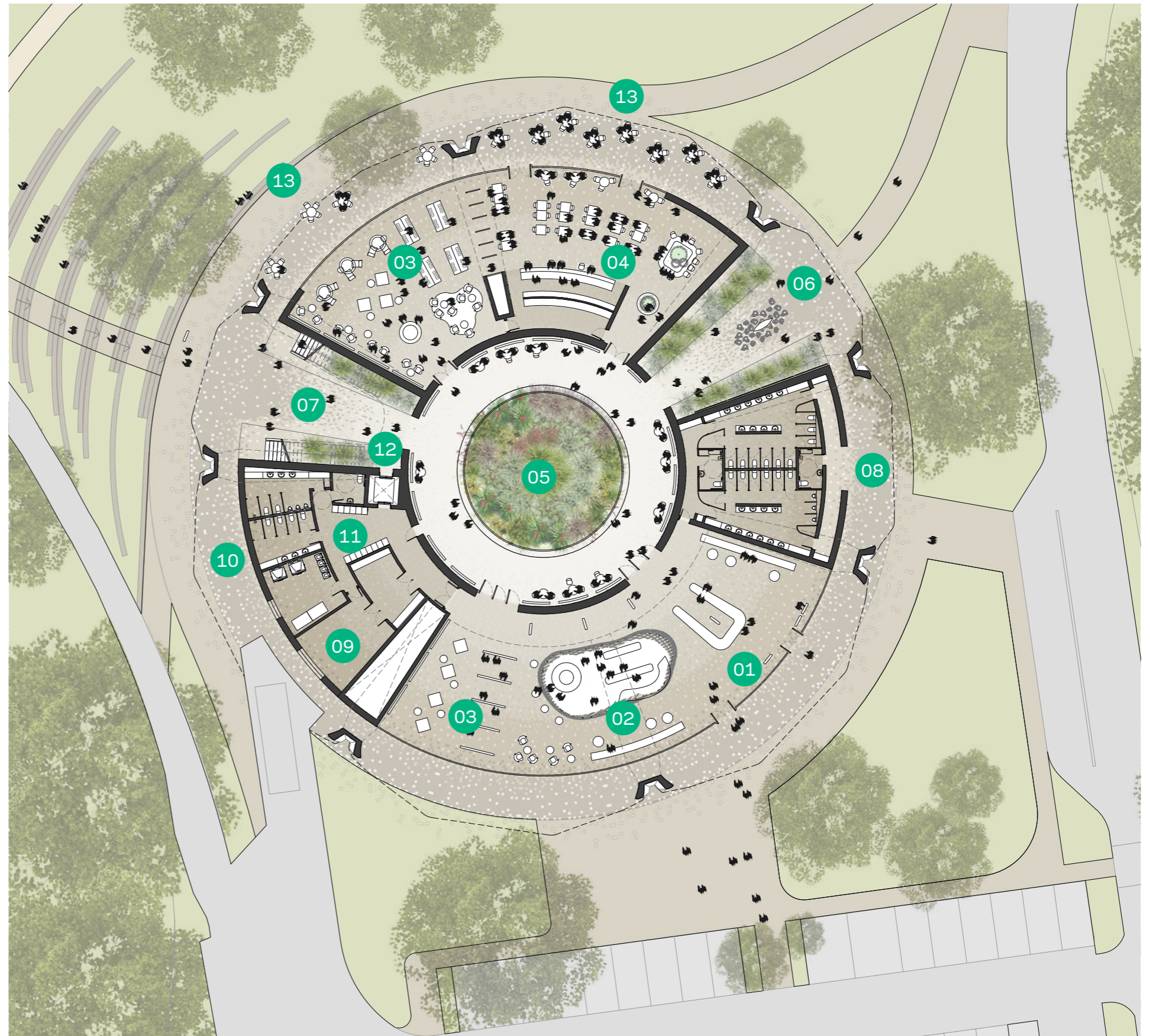

Connection to Country



Meeting Place Arrival Hall
Interior Perspective

The Welcome Wall arrival



Welcome Wall Entrance & Cafe via Commemoration Flat
Exterior Perspective

The Reception



Visitor Centre - Reception, Visitor Information,
Retail and Exhibition
Interior Perspective

Dhai'mun (Damun, Tamnun) Visitor Centre

Level One Plan

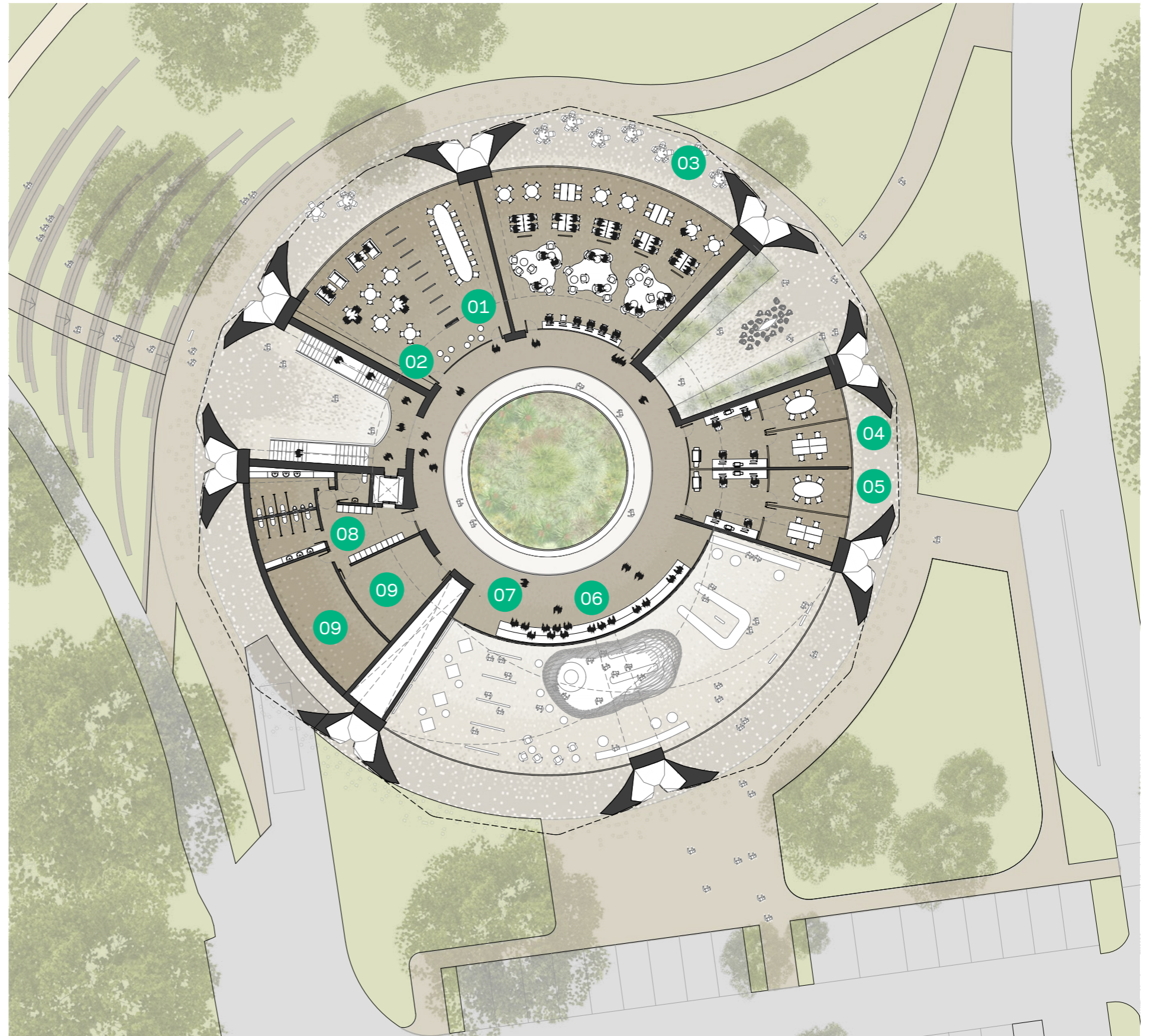

Program & Function

- 01. Meeting Room
- 02. Staff Kitchen and Lounge
- 03. Education
- 04. NPWS Office
- 05. DoE Office
- 06. Covered Outdoor Learning Area
- 07. Integrated Interpretation Walkway
- 08. Amenities
- 09. Store & Plant Room

Dhai'mun (Damun, Tamnun) Visitor Centre
 The Banks Florilegium Garden

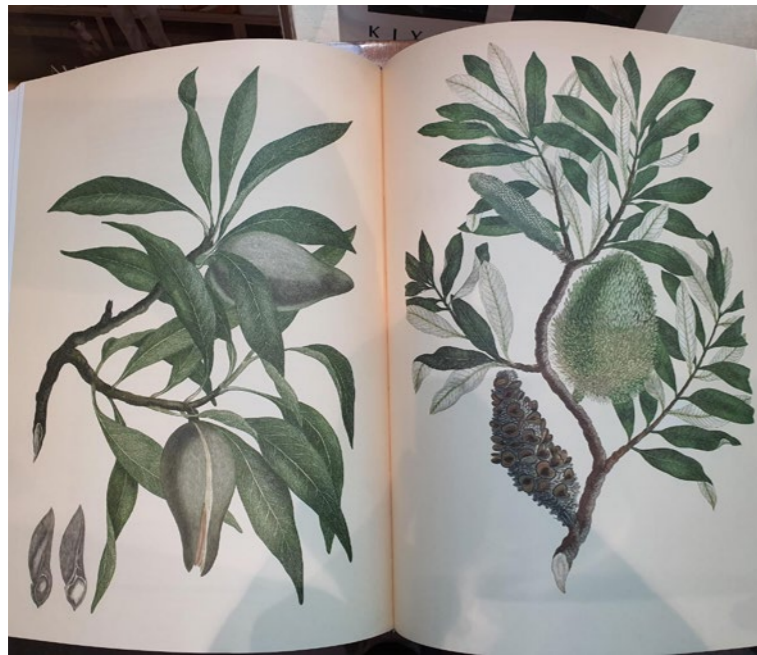

Extract from Joseph Banks' Florilegium:
 Botanical Treasures from Cook's First Voyage



Copper Plates by Joseph Banks



Level 01 view towards Collection Garden
 Interior Perspective

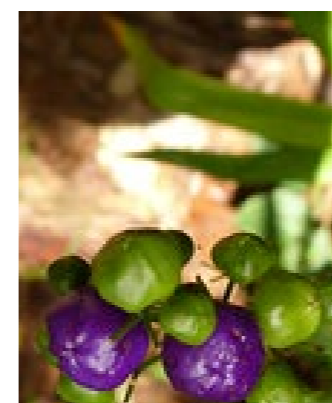
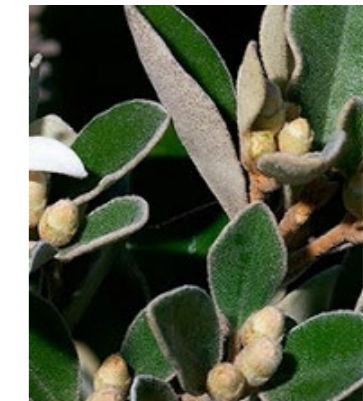

The Collection Garden



Education and Covered Outdoor Learning Area view through to Collection Garden Interior Perspective

Dhai'mun (Damun, Tamnun) Visitor Centre

Materials and Textures

Material Palette Building Materials

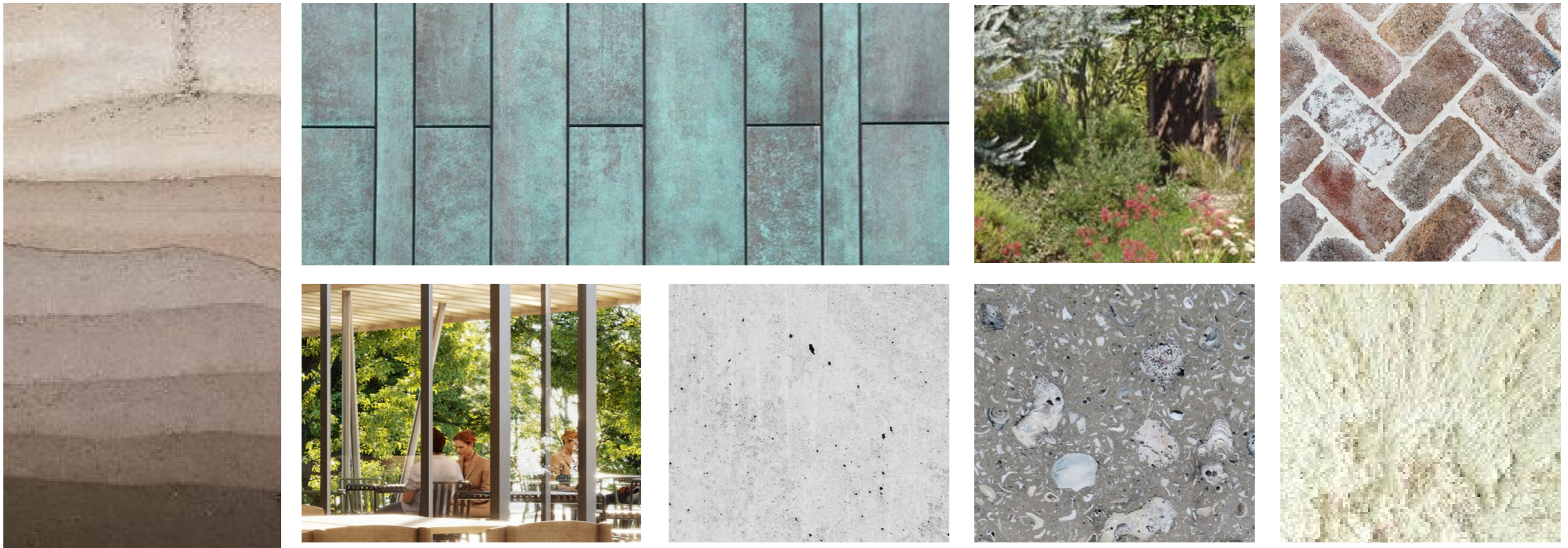

Section 01 Reception retail through to Meeting Place Arrival Hall



01. Arrival from Carpark

03. Central Garden

05. Level 01 COLA

07. Connection to the Meeting Place

02. Visitors Information / Reception

04. Open to Sky Atrium

06. Arrival Hall, Welcome

The Meeting Place arrival



Meeting Place Arrival Hall
Exterior Perspective

The Cafe



Cafe view towards Commemoration Flat
Interior Perspective



1.



2.



3.

References

- 01. Warrigal, Spinach
- 02. Daucus Carota, Flower
- 03. Daucus Carota, Wild Carrot

Master Plan Experiences

Commemoration Flat, Picnic and BBQ Facilities



BBQ Pavilions
Modular structures provide communal environments with framed views



Wattles



Design Inspiration, Photograph of Fig Tree on site



Enduring views towards Commemoration Flat towards water



Master Plan Experiences
 Banks Monument Enhancements



The Banks Monument
 A place for education and stories reflective of the significance of the site



Copper Plates by Joseph Banks



Bangawarra explaining the significance of the banksia in both Aboriginal and European contexts.



Extract from Joseph Banks' Florilegium: Botanical Treasures from Cook's First Voyage

Master Plan Experiences

Landing Precinct



The natural guttering system of the cabbage tree palm fronds.

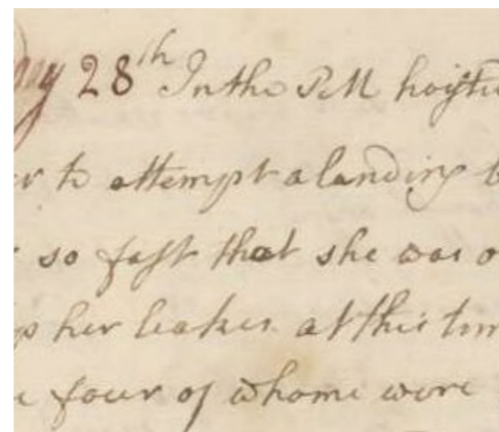

Cook's Journal National Library of Australia



Photograph of Lilly Pilly

Landing Precinct

- 01. Future Ferry Wharf
- 02. Sculpture Shell Seating Elements
- 03. Cabbage Palm Clusters
- 04. Expanded Hard-stand
- 05. Additional Bench Seating to Ferry Hut
- 06. New Informal Path to Cook Obelisk
- 07. Lilly Pilly Plantings

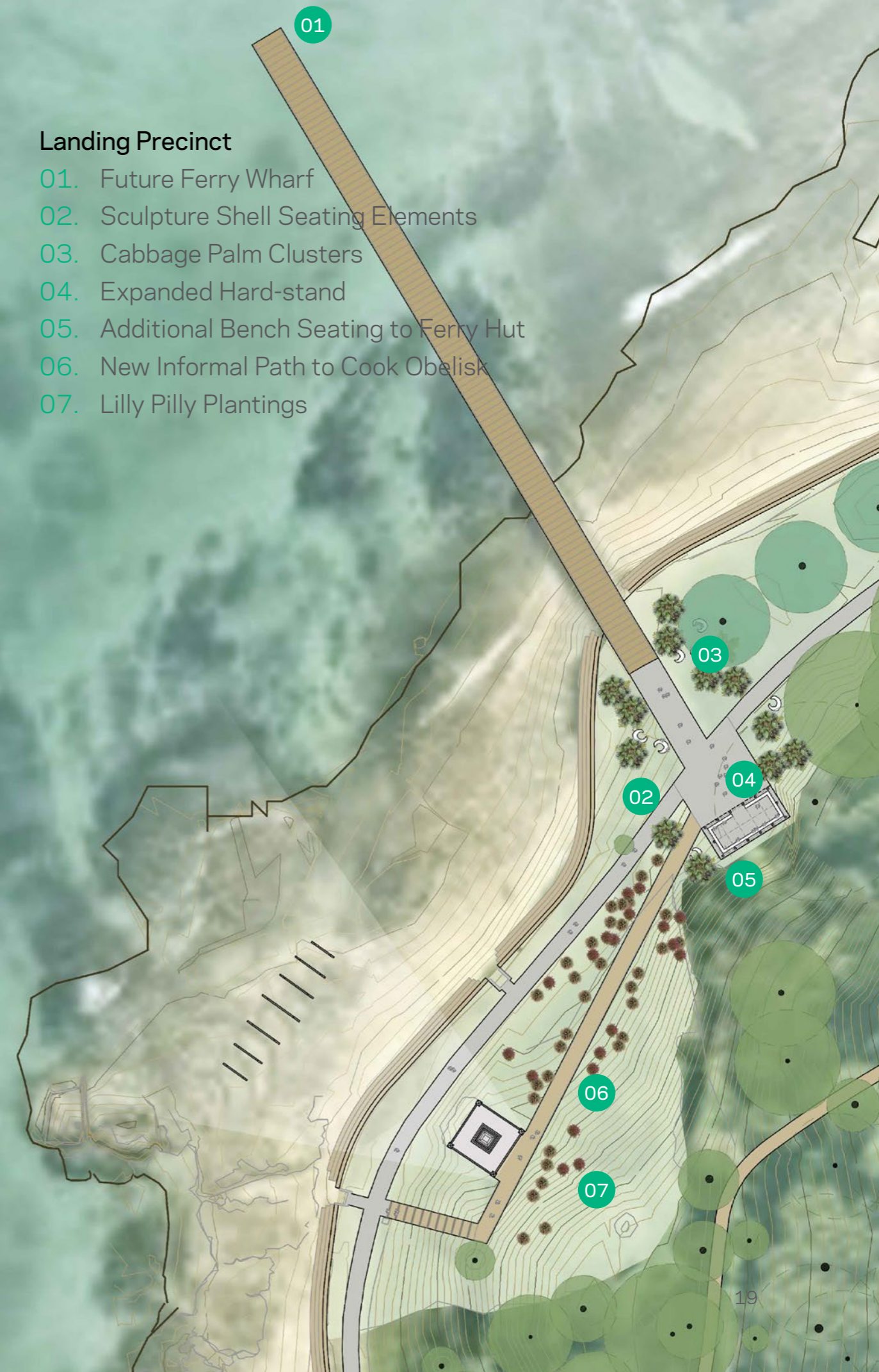

Master Plan Experiences
Procession To The Whales



Wi-Yanga and Gurung The Whales at
Kamay Botany Bay National Park



Photograph of Gynea Lilly
Doryanthes Excelsa



Photograph of a whale at Botany Bay



The Meeting Place



Meeting Place view towards Visitor Centre
Exterior Perspective

Overall Master Plan

Bangawarra and Crone

Master Plan Elements

01. Landing Precinct, Cook Monument improved access and landscape overlay
02. Whale Bone Sculpture - existing
03. Ferry Hut arrival/departure space upgrades, civic furniture and landscape
04. Future ferry wharf arrival
05. Upgrades and landscape improvements to Banks Monument
06. Foreshore planting revitalisation
07. Existing freshwater stream crossing
08. Existing canoe sculptures and formalised beach stair access
09. Rock revetment sea wall and adjacent promenade extension as accessible walkway
10. Ramped walkways/lookout points to whale sculptures and La Perouse
11. Existing whale sculpture, inscription point access
12. Commemoration Flat
13. Upgraded amenities block/showers
14. New Picnic/BBQ shelters
15. Informal access path/landscape enhancements
16. Loop path/car park access upgrade
17. Proposed Visitors Centre
18. Re-instate open freshwater stream and crossing to cricket pitch site including landscape upgrades
19. The Meeting Place upgrades
20. Vehicular access/shared path to Alpha Farm House
21. Alpha Farm House
22. Burrawang Walk - existing
23. Upgraded cricket pitch amenities
24. Cricket Pitch car park
25. Possible future car park extension
26. Retained car park overflow to cricket pitch/open recreation area
27. Retained Visitors Centre car park/minor upgrades
28. Retained Commemoration Flat car park/minor upgrades, resurfacing
29. Improved signage/arrival moment
30. Loading path/access extension from existing car park
31. Future Vehicular arrival/signage Upgrades



DISCLAIMER

This report was prepared by Crone Bangawarra in good faith exercising all due care and attention, but no representation or warranty, express or implied, is made as to the relevance, accuracy, completeness or fitness for purpose of this document in respect of any particular user's circumstances. Users of this document should satisfy themselves concerning its application to, and where necessary seek expert advice in respect of, their situation. The views expressed within are not necessarily the views of the Department of Planning, Industry and Environment and may not represent Department policy.

© Copyright State of NSW and the Department of Planning, Industry and Environment